

“WOG - 3000” High Pressure Ball Valve

FlowBiz WOG 3000 Ball Valve series are low torque engineered for high-pressure applications. Features include live loaded stem seals, replaceable seats and seals, and nickel plating on carbon steel bodies. Other body materials are available upon request—threaded and extended socket welded connections.

Size Range : 1/2 inch to 2 inch (15mm to 50mm)

End Connection : Screwed End

Key Features :

- Rugged 3 piece designed construction.
- Full Port / Bore.
- Grounded Ball and Stem
- As per NACE MR0175
- As per API 607 Locking & Spring Return Lever.
- Threaded Ends to ASME B1.20.1



Item	Type of Test	Testing Pressure	Working Pressure	Temperature
Valve Body Screwed End	Hydraulic	300 Kg / Cm ²	200 Kg / Cm ²	150 ° C

No.	Description	Material	Qty.
1	Handle	WCB / CF8 / CF8M	01
2	Stem Pin	S. S. 304 / S. S. 316	01
3	Spacer Ring	S. S. 304 / S. S. 316	01
4	Stem Seat	S. S. 304 / S. S. 316	01
5	Ball Seat	Peek / Polyacetal	02
6	End Connector	WCB / CF8 / CF8M	02
7	'O' Ring	NBR / EPDM / Viton	02
8	Body Seat	Graphite	01
9	Fitting Stud	H.T. / CF8	01
10	Body	WCB / CF8 / CF8M	01
11	'O' Ring	NBR / EPDM / Viton	01
12	Gland Packing	Peek / Polyacetal	01

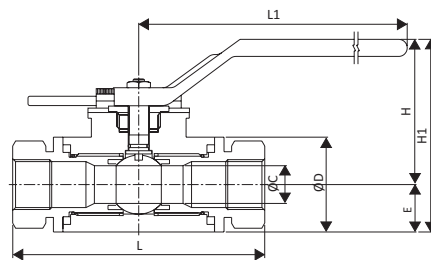
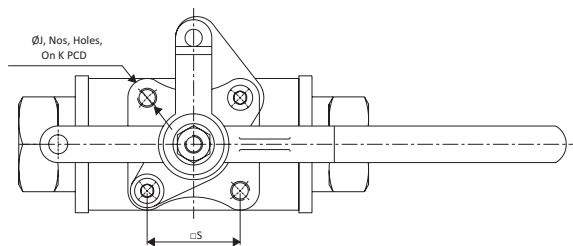
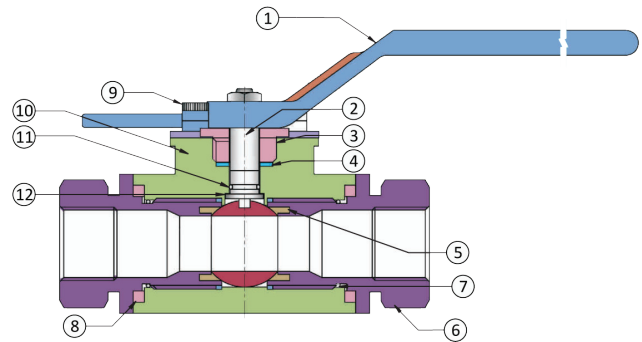

Dimensions : (All Dimensions are in mm)

Valve Model	Valve Size		L1	L	H	ØC	ØD	□S	ØJ	N	K : PCD	Weight (Approx) Kgs
	MM	Inch										
FB-WOG - 15	15	1/2"	160	98	75	12.7	39	25.4	M5X0.8	4	36	1.330
FB-WOG - 20	20	3/4"	205	108	90	17.5	48	31	M6X1	4	42	1.440
FB-WOG - 25	25	1"	205	108	96	22.3	55.5	31	M6X1	4	42	2.100
FB-WOG - 32	32	1 1/4"	255	133	124	31.8	76.5	35.3	M6X1	4	51.5	4.850
FB-WOG - 40	40	1 1/2"	255	133	124	31.8	76.5	35.3	M6X1	4	51.5	4.280
FB-WOG - 50	50	2"	255	159	125	38.1	89.5	35.36	M6X1	4	51.5	7.420

